

15 CORNELL ROAD



SITE DETAILS & INFORMATION

- Approximately 5,434 rentable square feet
- Second floor space overlooking pond
- Class A office building with ample parking
- Convenient location near Shaker Ridge Country Club and the multi-use path



15 CORNELL ROAD

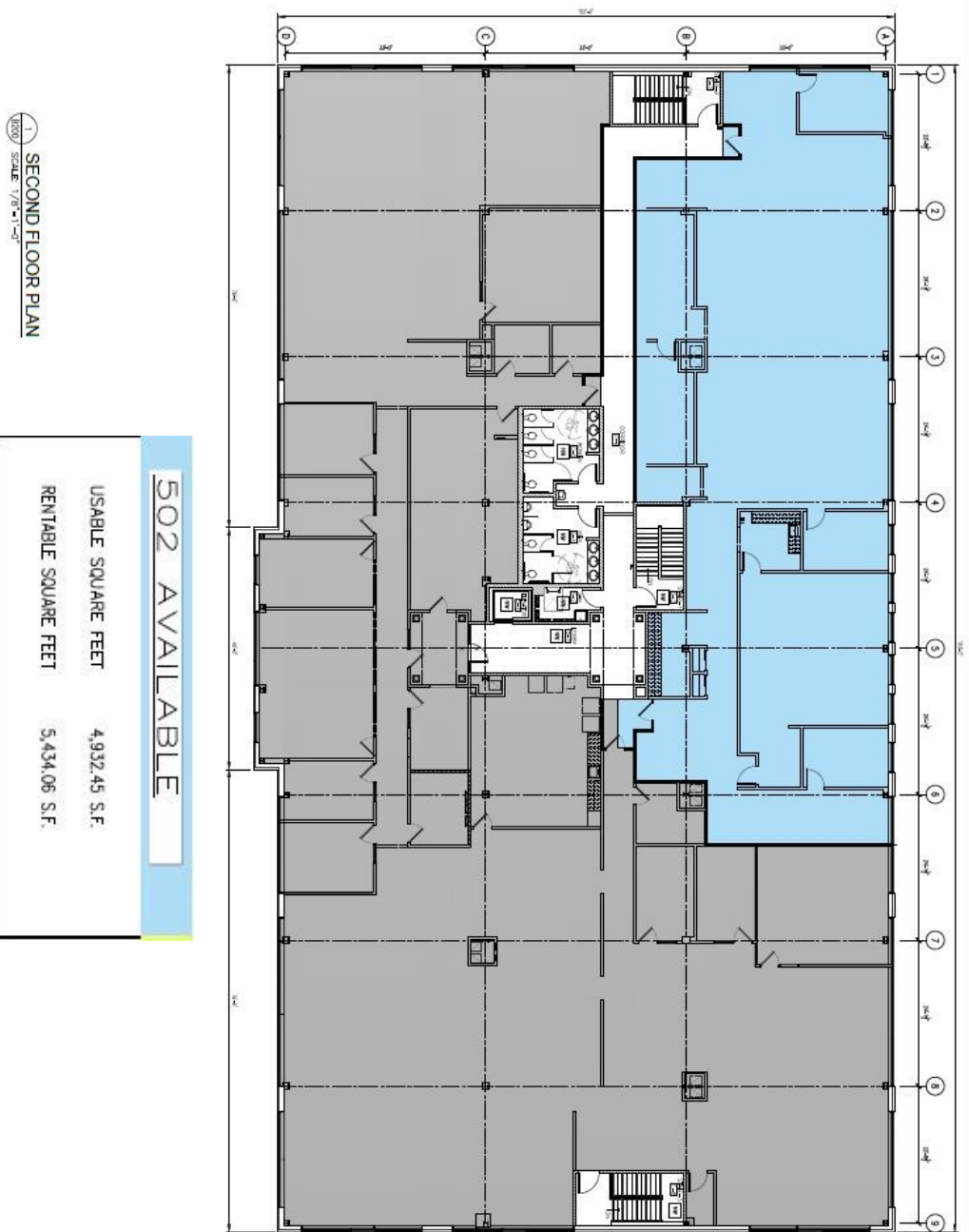

1 SECOND FLOOR PLAN
SCALE 1/8" = 1'-0"

502 AVAILABLE	
USABLE SQUARE FEET	4,932.45 S.F.
RENTABLE SQUARE FEET	5,434.06 S.F.

<p>DATE: 1/26/2010 DRAWN BY: [REDACTED] CHECKED BY: [REDACTED] APPROVED BY: [REDACTED]</p>	<p>2 STORY OFFICE BUILDING</p> <p>British American Development BOMA Plans 15 Cornell Road LAWRENCEVILLE, NY 11940</p>	<p>British American Development</p> <p>25 British American Blvd., Larchmont, NY 10500 PH: 516.278.6000 FAX: 516.278.6001 http://www.britishamerican.com</p>
--	--	--